

**AKSA Power Generation** has been producing industrial generator sets with an innovative compact design and excellence in quality for over **30 years**. AKSA has been providing reliable power through three main production plants and over 15 branch offices worldwide.



**General Characteristics**

Model Name	<b>APD2500M-6</b>	Frequency / PF	<b>60Hz, 1800 rpm, 0.8pf</b>
Engine Make & Model	<b>Mitsubishi S16R-PTAA2</b>	Alternator Make	<b>Stamford</b>
Control Panel Model	<b>DSE 7320</b>	Base Frame / Enclosure	<b>AK99/ISO CONTAINER</b>

**Genset Rating – 60Hz, 1800rpm, 0.8pf**

Engine	Alternator	Voltage	Standby Power	Prime Power	Standby Current
S16R-PTAA2	PI734F (Wnd-312)	480 / 277V	2540kVA	2295kVA	3055A
	PI734F (Wnd-13)	380 / 222V	2540kVA	2295kVA	3859A
	N.A.	220 / 127V	-	-	-
	N.A.	208 / 120V	-	-	-

Stand-by Power (Maximum): Power available at variable load in the event of main power network failure. No over load is permitted.

Prime Power: Power available at variable load in lieu of a main power network. Overload of 10% is permitted for 1 hour in every 12 hours of operation.

The above ratings represent the engine performance capabilities to conditions specified in accordance with ISO 8528/5 & ISO3046.

**Derating may be required for conditions outside of the test conditions.**

**Codes & Standards**

The Generator set is designed and manufactured in a facility certified to **ISO9001** standards.

The Generator set is designed and manufactured in a facility certified to **ISO14001:2015** standards.

**AKSA Power Generation** provides **single source responsibility** for the generator set & accessories.

The generator set, with its components, are **prototype tested** and **production tested**



\*Manufacturer reserves the right to make changes in model, technical specifications, color, equipment and accessories without prior notice.

**Engine Data**

Manufacturer	Mitsubishi
Model	S16R-PTAA2
Displacement & Cylinders	65.37 L / 16 Cylinders
Engine Speed	1800rpm
Engine Standby Power wo/Fan	2149 Kw
Engine Prime Power wo/Fan	1939 kW
Aspiration	Turbocharged, Air to Air Cooler
Compression Ratio	14:1
Bore / Stroke	170 mm / 180 mm
Break Mean Effective Pressure	2.19 Map
Mean Piston Speed	10.8 m/s
Allowable Fan Loss Power	50 Kw
Max Regenerative Power Absorption Capacity wo Fan	192 Kw
Steady State Speed Stability	± 0.25 %
Max Over Speed Capacity	2100 rpm
Wet Weight – Engine Only	6820 kg

**Fuel System**

Fuel Injector	Mitsubishi PS6 Type x 2
Max Suction of Feed Pump	75 mmHg
Max Static Head of Return & Leak Pipe	150 mmHg

**Fuel Consumption**

Standby Power (110%)	515 l/h
Prime Power (100%)	469 l/h
Prime Power (75%)	351 l/h
Prime Power (50%)	234 l/h
Prime Power (25%)	117 l/h

**Electric System**

Battery Charge Alternator	24V / 30Ah
Starting Motor Capacity	7.5 kW x 2
Battery Qty, Rating	4 x 200Ah

**Cooling System**

Radiator Cooling System Type	Closed Circuit
Radiator Ambient Temp	> 50 °C
Coolant Capacity, Engine Only (Jacket & Air Cooler)	413 l
Max Coolant Temp at Engine Outlet	98 °C
Thermostat, Start – Fully Open	71– 85 °C

**Exhaust System**

Exhaust Outlet Size	202 mm
Max Allowable Back Pressure	600 mmH <sub>2</sub> O
Exhaust Gas Flow	514 m <sup>3</sup> /min

**Air Intake System**

Intake Air Flow	194 m <sup>3</sup> /min
Max Intake Air Restriction (Clean Element)	400 mmH <sub>2</sub> O
Air Filter Type	Dry Paper Element

**Lubrication System**

Total System Capacity	230 l
Sump Capacity Max / Min	200 l / 140 l
Max Oil Temp	110 °C
Oil Pressure at Rated Speed	71 – 93 psi

**Alternator Data**

Manufacturer	Stamford
Standards	BS EN 60034
Control System	PMG
A.V.R.	MX321
Voltage Regulation	± 0.5 %
Insulation System	Class H
Protection	IP23
Rated Power Factor	0.8
Stator Winding	Double Layer Concentric
Winding Pitch	Two Thirds
Winding Leads	12
Telephone Interference	THF < 2 %
Waveform Distortion	No Load < 1.5 %
Maximum Over speed	2250 rev/min

**Battery Charger & Electrical System Data**

Manufacturer	AKSA
Model	SmartGen BAC06A
Input Voltage	100V ~ 250V AC
Output Voltage / Current	27,6V DC / 3A

**Jacket Water Heater Data**

Manufacturer	AKSA
Model	HTR4000
Input Voltage	Based on Genset Voltage
Power	2 x 4000W

**Controller Data**

Manufacturer	DSE
Model	7320
Type	Auto Mains Failure Control

**Controller Features & Benefits**

- Microprocessor controlled
- License free PC Software
- IP65 rating offers increased resistance to water ingress
- Modules can be integrated to building management systems
- Real time clock provides accurate event log
- Four line back-lit LCD text display
- Five key menu navigation
- Front panel editing with PIN protection
- Support up to three remote display modules
- Configurable timers and alarms
- Multiple date and timer scheduler
- Integral PLC editor
- 'Protections disabled' feature
- kW & kVAR protection
- Reverse power (kW & kVAR) protection
- Power monitoring (kWh, kVAR, kVAh, kVArh)
- Load switching (load shedding and dummy load outputs)
- Unbalanced load protection
- Independent Earth Fault trip
- Fully configurable via DSE Configuration Suite PC Software
- SCADA monitoring via DSE Configuration Suite PC Software

**Enclosure Features**

- ✓ Heavy Duty Steel Structure
- ✓ E-Stop on Enclosure
- ✓ Control Panel Eliminated from Engine Vibrations
- ✓ Control Panel Window
- ✓ Plastic Covered Corrosion Resistant Locks & Hinges

**Enclosure Features**

- ✓ Externally Mounted Exhaust System with Rain Cap
- ✓ Coolant Fill Cap
- ✓ Top Lifting Feature
- ✓ Standalone Fuel Tank
- ✓ Easy Access for Maintenance

**Open Skid Gen-Set Dimensions**

Length	5815mm
Width	2190 mm
Height	3390 mm
Dry Weight	13450 kg
Tank Capacity	-

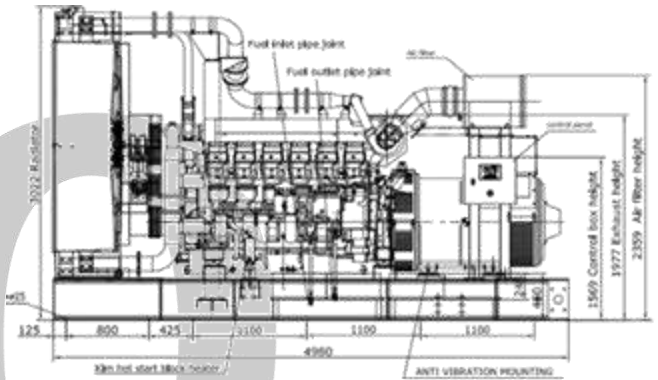

**Enclosed Gen-Set Dimensions – AK99 CANOPY**

Length	9000 mm
Width	2800 mm
Height	4394 mm
Dry Weight	19000 l
Tank Capacity	2000 L
Sound Pressure @ 7 meters	N.A.

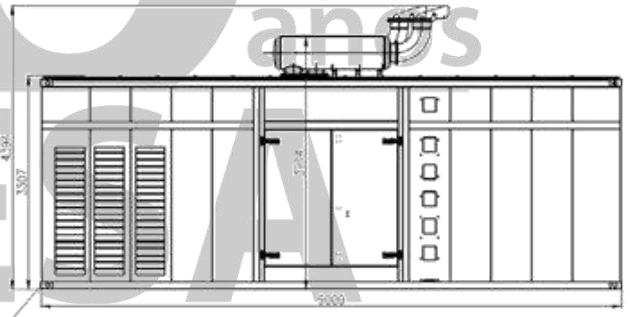

**Enclosed Gen-Set Dimensions – ISO CONTAINER**

Length	12192 mm
Width	2438 mm
Height	2896 mm
Dry Weight	24000 kg
Tank Capacity	-
Sound Pressure @ 7 meters	84 dB(A)

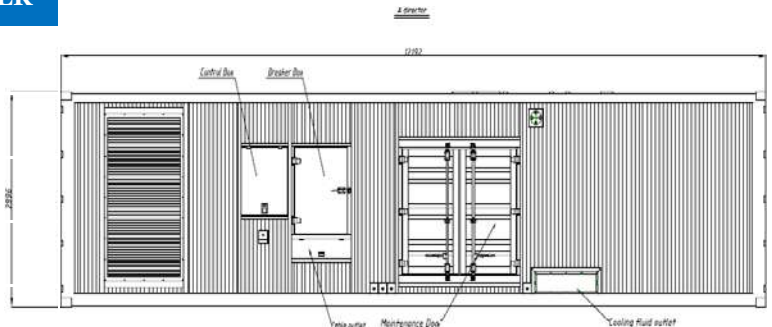

**Standard Features & Accessories**

- ✓ Heavy Duty Steel Base Frame
- ✓ Integral Fuel Tank
- ✓ PMG w/MX321 AVR
- ✓ Engine Jacket Water Heater
- ✓ Battery and Battery Rack
- ✓ Battery Charger
- ✓ Battery Restraint
- ✓ Anti Vibration Pads between Engine/Alternator & Base Frame
- ✓ Residential Grade Silencer Inside Enclosure
- ✓ Industrial Grade Silencer Set for Open Skid Sets
- ✓ Sound Absorb Foam for Enclosure
- ✓ Air Inlet & Outlet Rodent Guards
- ✓ Oil Drain Valve
- ✓ Coolant Drain Valve
- ✓ Flex Fuel Lines
- ✓ Air Filter Restriction Gauge
- ✓ Engine Manifold Cover
- ✓ Turbocharger Cover
- ✓ Protection Covers for Rotating Parts
- ✓ Exhaust Insulation Cover
- ✓ Control Panel Window
- ✓ Operations Manual
- ✓ 24 Months / 2000 hours Limited Standby Warranty

**Optional Accessories**

- Main Line CB (3 / 4 Poles)
- Anti-condensation Heater
- Stand Alone Bulk Fuel Tank
- Fuel Level Display & Alarm on Controller
- Low / High Fuel Alarms
- Fuel Water Separator Filter
- Auto Fuel Fill Control System
- Oil Temperature Display on Controller
- Manual Speed Adjust Rheostat
- Manual Voltage Adjust Rheostat
- Remote Annunciator Panel
- Remote Control & Monitoring Panel
- Advanced SMS Messaging
- Control Panel Heater
- Battery Disconnect Switch
- Battery Heater
- 10A Battery Charger
- Battery Charge Ammeter
- Tool Kit for Maintenance
- Power Plug Outlet Kit
- Automatic Transfer Panel (ATS) – Contactor Design
- Automatic Transfer Panel (ATS) – Changeover Design

\*Manufacturer reserves the right to make changes in model, technical specifications, color, equipment and accessories without prior notice.

**SEDE PRINCIPAL:**

Av. Nicolás Ayllón N° 2241 – Ate – Lima – Perú  
Telf.: (51-1) 748-3333 / 326-0411 / Anexo 1152

